

Surface-mounted rack and pinion door closer



Product features

- ▶ Variable closing force in two sizes achieved by simply turning the link arm's power shoe:
 - 'Weak' for leaf widths up to 850 mm (closing force size 2 to EN 1154)
 - 'Strong' for leaf widths up to 950 mm (closing force size 3 to EN 1154)
- ▶ Increased closing force due to offset installation for leaf widths up to 1100 mm (closing force size 4 to EN 1154)
- ▶ Closing speed and latching action adjustable
- ▶ Option: with hold-open link arm allowing the closer to hold doors open between 70° and 150°

Specifications

Overhead rack and pinion door closer GEZE TS 1000 C with adjustable closing speed and adjustable latching action, also available with mounting plate.

Finish:

- () silver
- () dark bronze
- () white
- () black
- () brass colored
- () RAL ...

Application range

- ▶ For single-action doors up to 950 mm (1100 mm)
- ▶ Can be used for right and left hand doors without adjustment
- ▶ For all common types of installation

<https://aros.kz>

Dimensions EN size 2/3

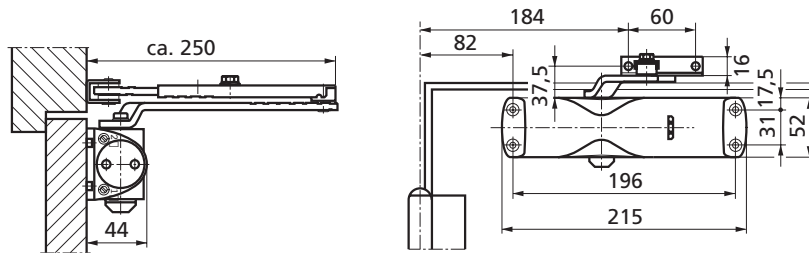

Dimensions EN size 4 max. opening angle approx. 110°

